

Cummins ISX15 / X15

Exhaust Manifold Installation

Instructions



“Congratulations on your purchase of the Diesel Power Source ISX15 / X15, high flow manifold. This manifold has been designed with the latest CFD software to maximize the exhaust flow with the lowest flow resistance. Please follow these installation instructions carefully to make sure you get the improved performance and the expected lifespan out of your new manifold.”



Upgraded DPS Gasket/Hardware Kit:

(Only Included if Purchased Separately!!!)

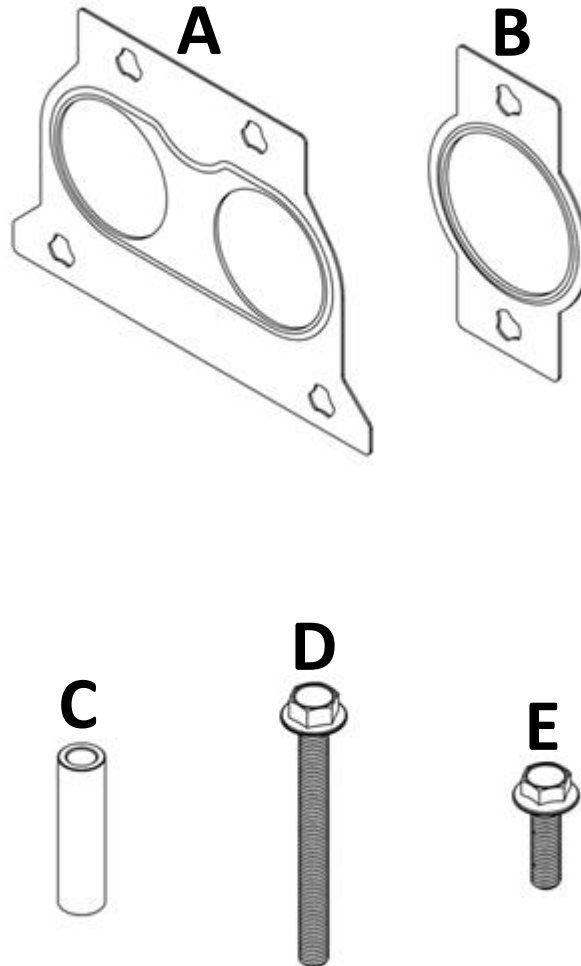

<u>Hardware Letter</u>	<u>Hardware Specification</u>	<u>Quantity</u>
A	Center Manifold Gasket	1
B	Outer Manifold Gasket	4
C	M10 x 60mm Spacer	12
D	M10 - 1.5 x 100mm Flange Head Bolt	12
E	M10 - 1.5 x 35mm Flange Head Bolt	2

Cummins ISX15 / X15 Exhaust Manifold

Installation Instructions:

Step 1: Install the manifold onto the engine block by following the diagram below. Set the OEM gaskets in place or if you purchased the upgraded DPS **A** and **B** gaskets. Use the OEM hardware or if purchased the upgraded DPS **C** spacers and DPS **D** bolts, to hold the manifold and gaskets in place by passing them through the top row of holes and finger tightening the bolts. After the manifold is held in place, continue to the bottom row to install the remaining bolts. If you purchased the upgraded DPS hardware kit, you received two additional DPS **E** bolts. These bolts can be installed on the two center bottom holes of the manifold in place of the DPS **C** spacers and DPS **D** bolts. Using these bolts makes installation much easier. Torque the bolts to **48 ft-lbs**.

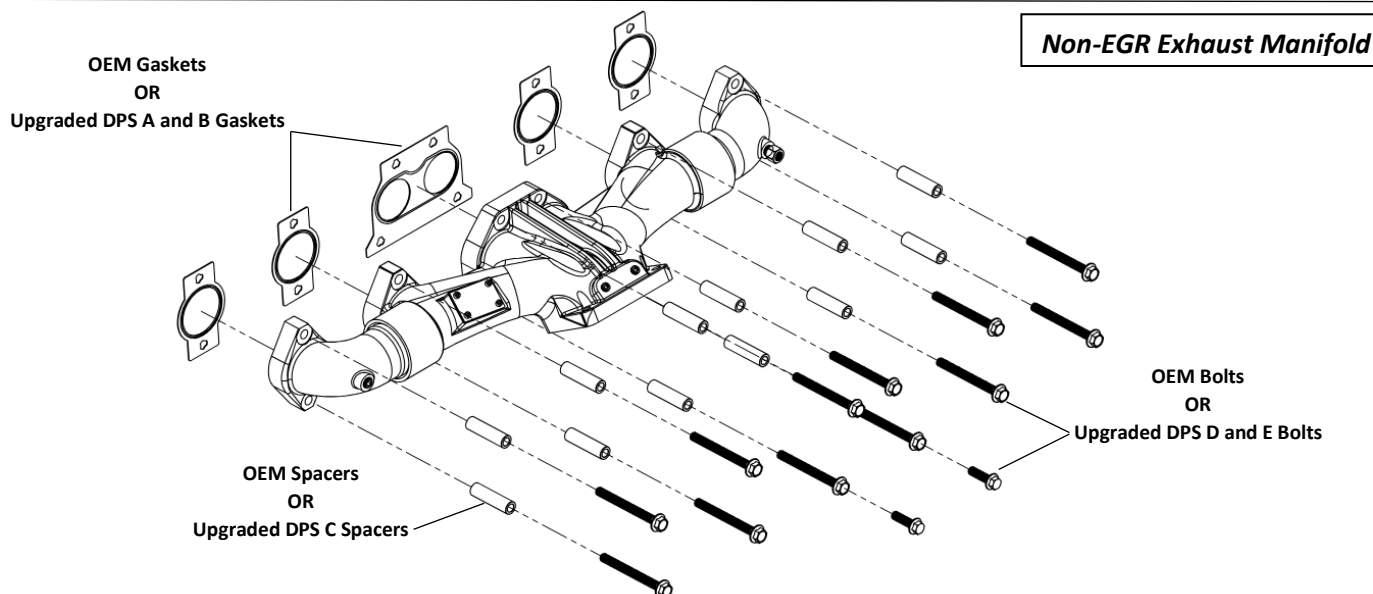
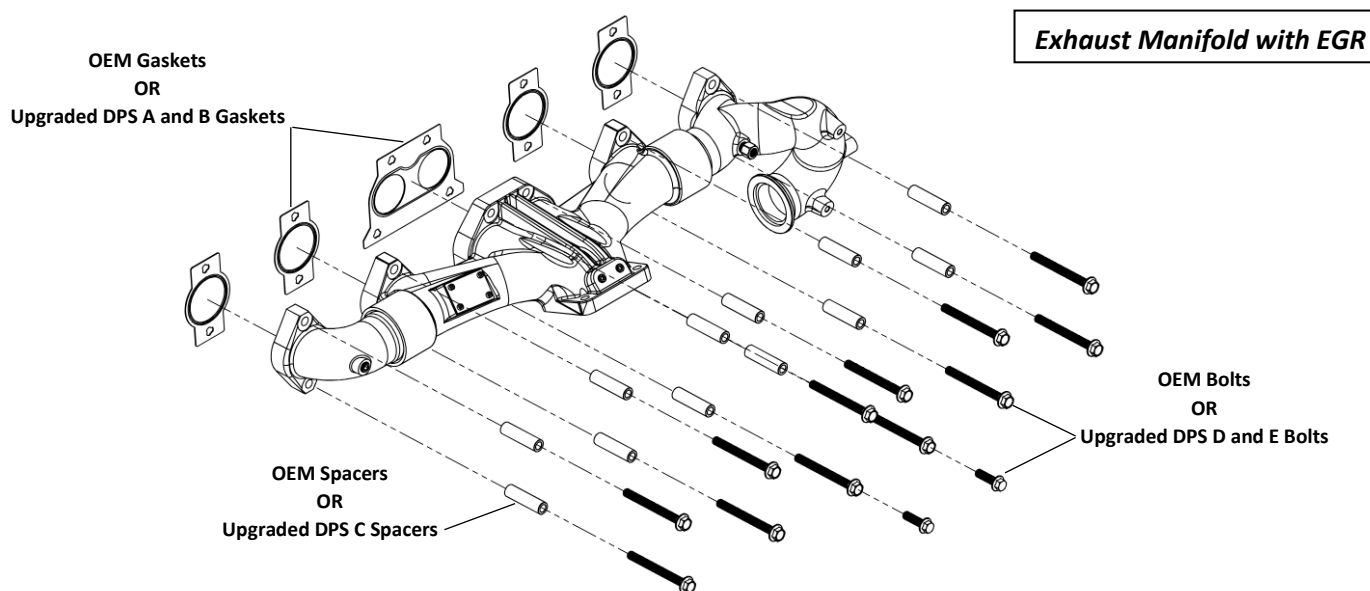

Step 2 (For Exhaust Manifolds with EGR): Connect the manifold to the EGR system by installing the OEM bellow pipe. (**Note:** If your truck does not have a bellow pipe connection. The bellow pipe can be purchased through Diesel Power Source to adapt it to your truck.)

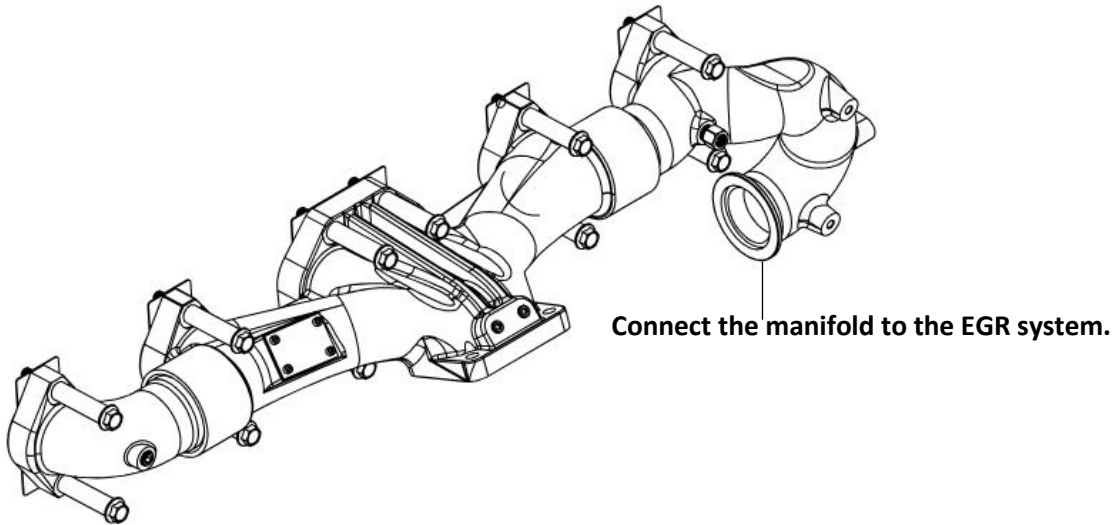

Step 3: Connect the exhaust pressure sensor reference tube to the adapter fitting located on the manifold. (**Note:** If your truck no longer requires the exhaust pressure sensor the adapter fitting can be removed and plugged with a 1/4" NPT plug fitting.)

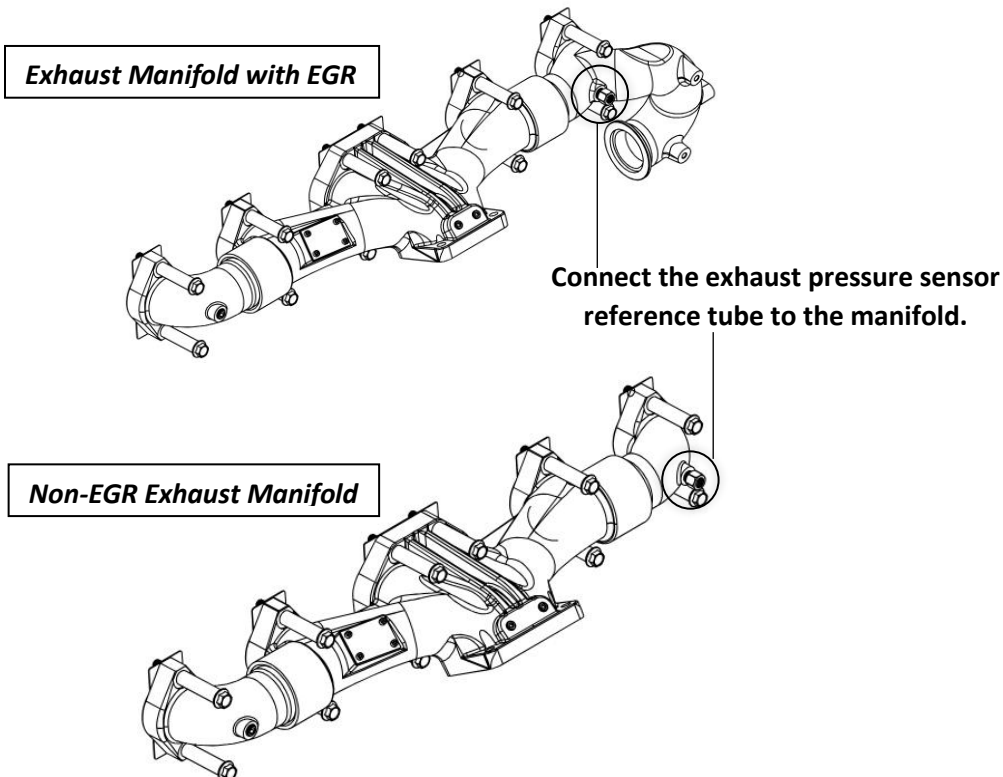

Step 4: Using your own hardware attach the turbo charge to the exhaust manifold. Torque the bolts to **48 ft-lbs.**

Exhaust Manifold with EGR

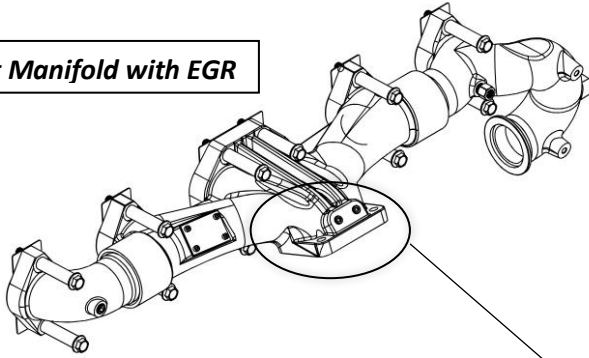

Non-EGR Exhaust Manifold

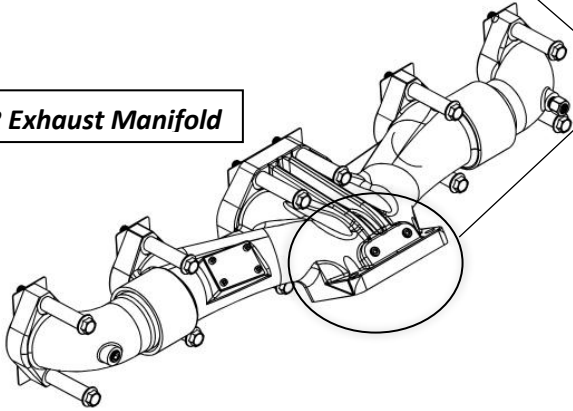

Attach the turbo charger to the manifold.

Step 5: After installation, drive the truck for approximately 100 miles then, while the truck is warm use gloves and re-torque all the manifold and turbo bolts, as the bolts sometimes loosen up after being heated and cooled a few times.