

T4 24V Manifold

Installation Instructions

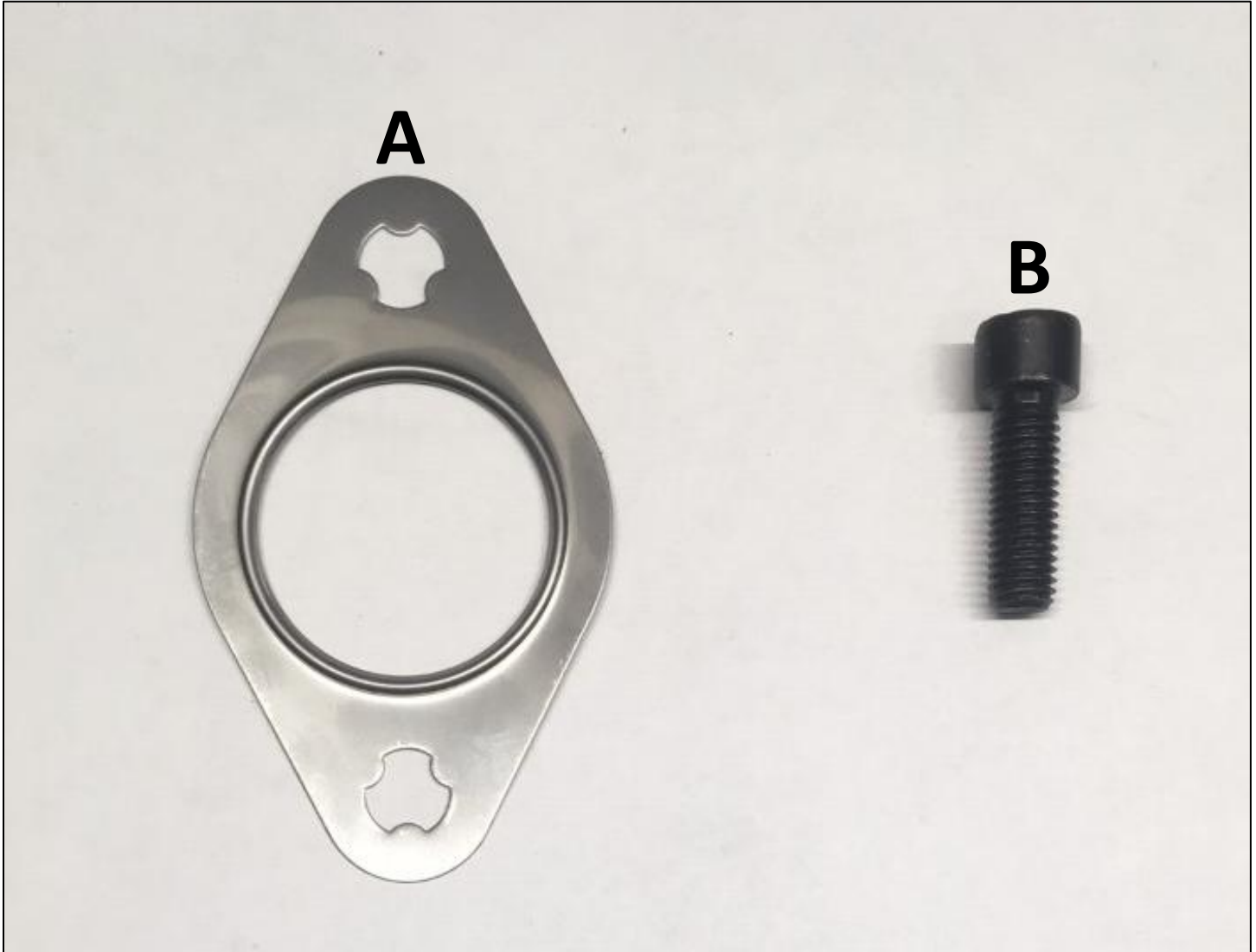

T4 Manifold Hardware



<u>Hardware Letter</u>	<u>Hardware Specification</u>	<u>Quantity</u>
A	24V Manifold Gasket	6
B	M10 – 1.5 x 30mm Socket Cap Screw	2

T4 Manifold Installation

Step 1: Connect your new Diesel Power Source T4 manifold to your turbo. Ensure a T4 gasket is placed between the manifold and turbo flange. Bolt threads need to be M10 - 1.5. **(Note: The manifold does not include the needed turbo mounting hardware or T4 gasket.)**

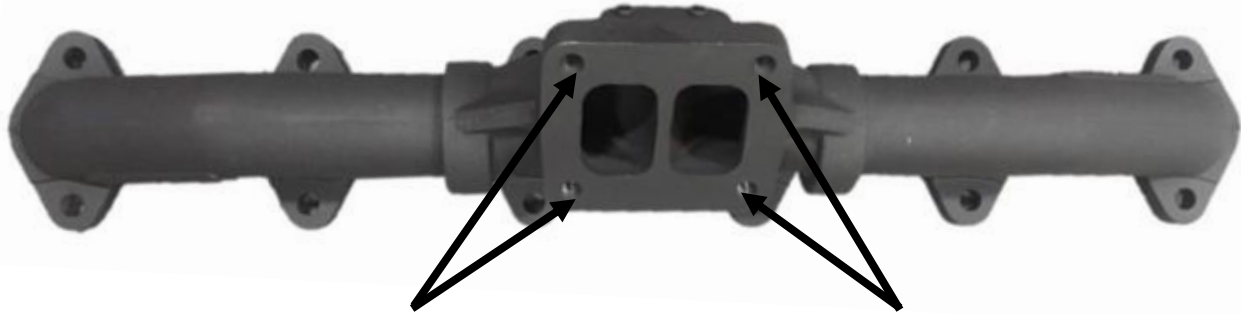

Manifold T4 flange thread size is M10 – 1.5

Step 2: Connect the manifold and turbo assembly to the head. Using the included **A** gaskets, **B** bolts, and stock manifold bolts. Be sure to place the **A** gaskets between the manifold and head with the raised portion of the gasket facing the manifold. Tighten bolts to 35 ft-lbs. The picture below shows the correct hardware locations

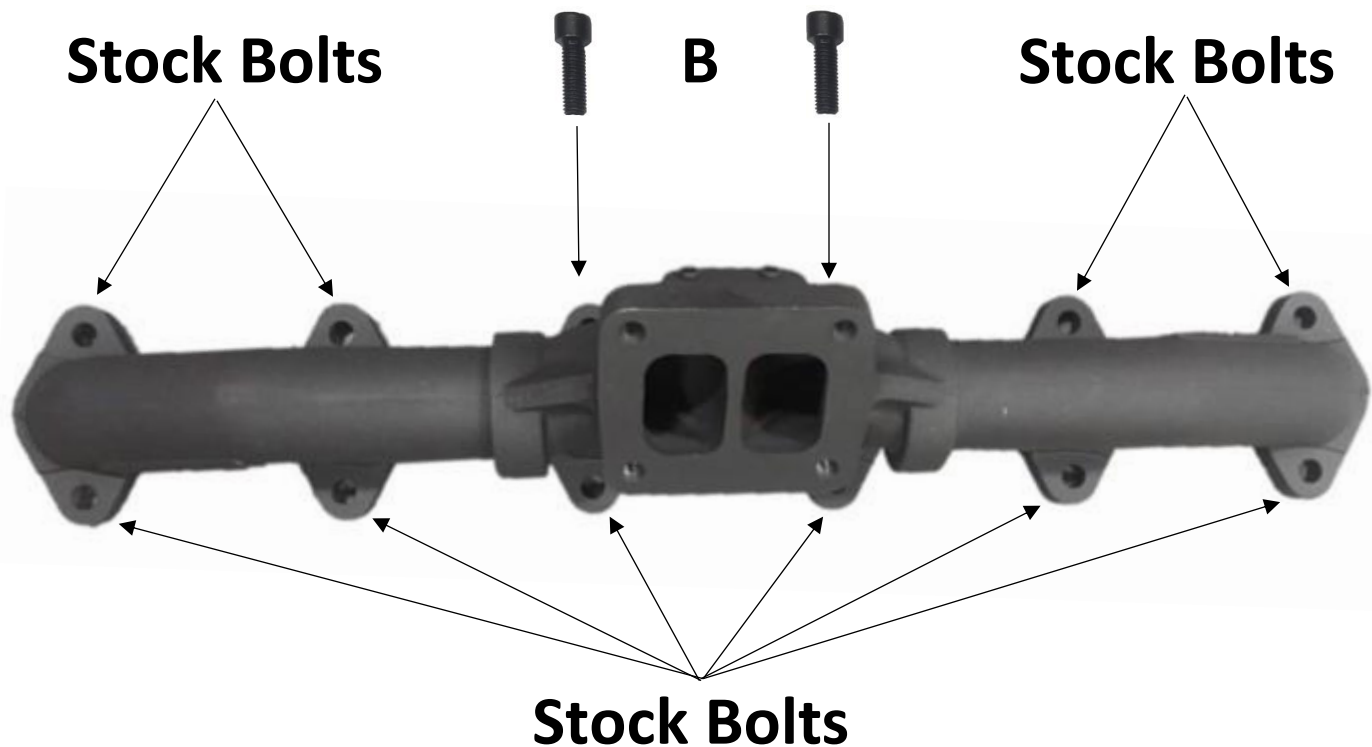

After installation, drive truck for approximately 100 miles then, while the truck is warm re-torque all the manifold and turbo bolts, as the bolts sometimes loosen up after being heated and cooled a few times.