

**Rear**

**Front**

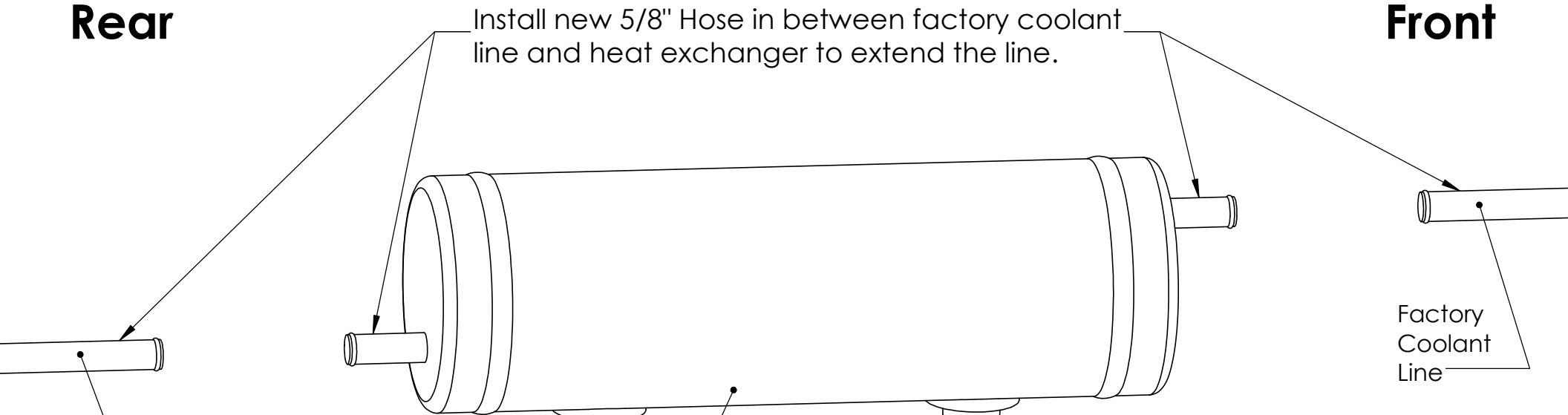

Install new 5/8" Hose in between factory coolant line and heat exchanger to extend the line.

Factory Coolant Line

Heat Exchanger

Factory Coolant Line

Replace this fitting with 45° elbow fitting and connect the new line to driver side transmission port using provided 1/4NPT fitting.

Factory Line

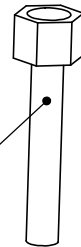

1. Remove this straight fitting and attach it to the factory line.
2. Install 45° elbow fitting where the straight fitting was originally located.
3. Install 90° elbow fitting to the factory straight fitting attached to factory line from step 1.
4. Use new steel braided line to connect the 45° elbow fitting to the 90° elbow fitting.

Drain coolant and transmission fluid prior to disconnecting. Drill two holes in the mounting Bracket. Mount it to the crossmember or any location you prefer. Use zip ties to secure all lines in place.